

Notes:
 This map is reproduced from/based upon Ordnance Survey material with the permission of Ordnance Survey on behalf of the Controller of Her Majesty's Stationery Office. © Crown Copyright. Unauthorised reproduction infringes Crown copyright and may lead to prosecution or civil proceedings. Glasgow City Council, 100023379.

- LEGEND**
- NEW FOOTWAY AREA
 - NEW CARRIAGEWAY AREA
 - GRASS VERGE
 - FLAT TOP HEEL KERB

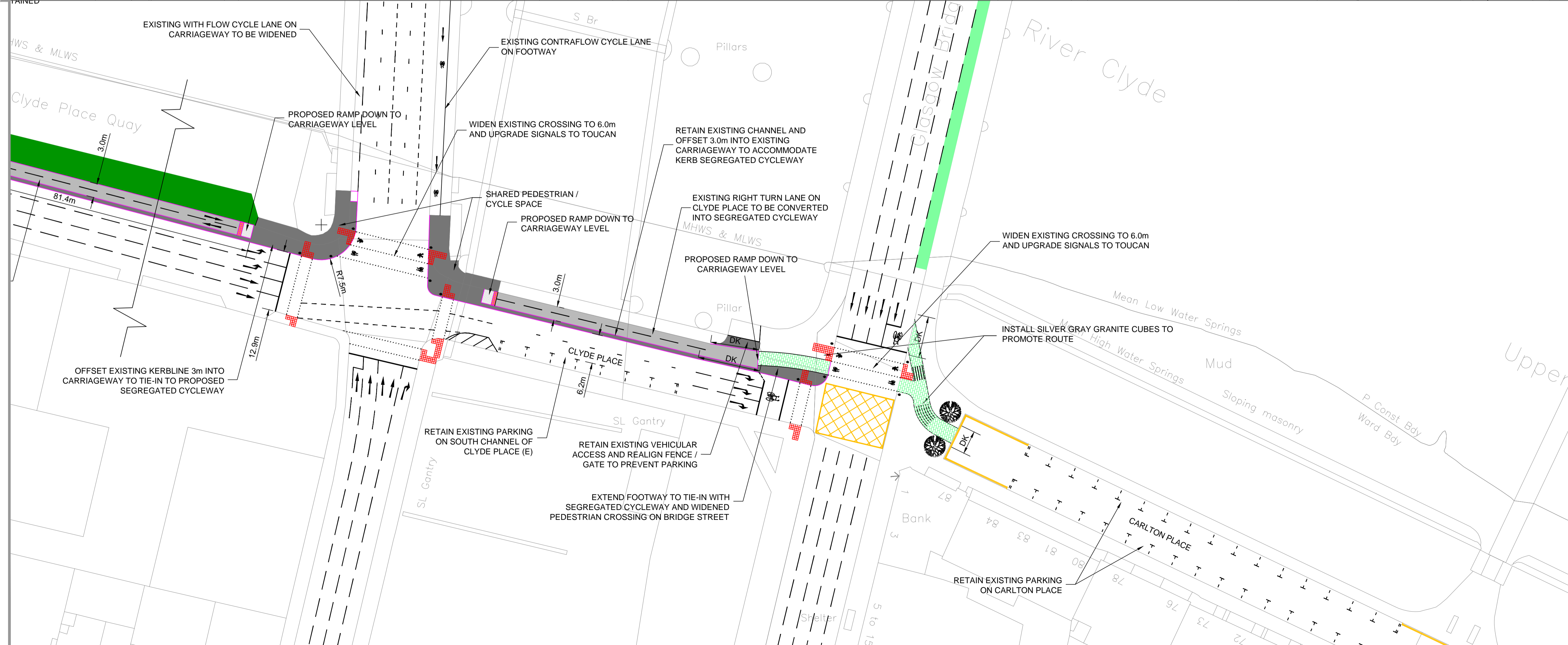
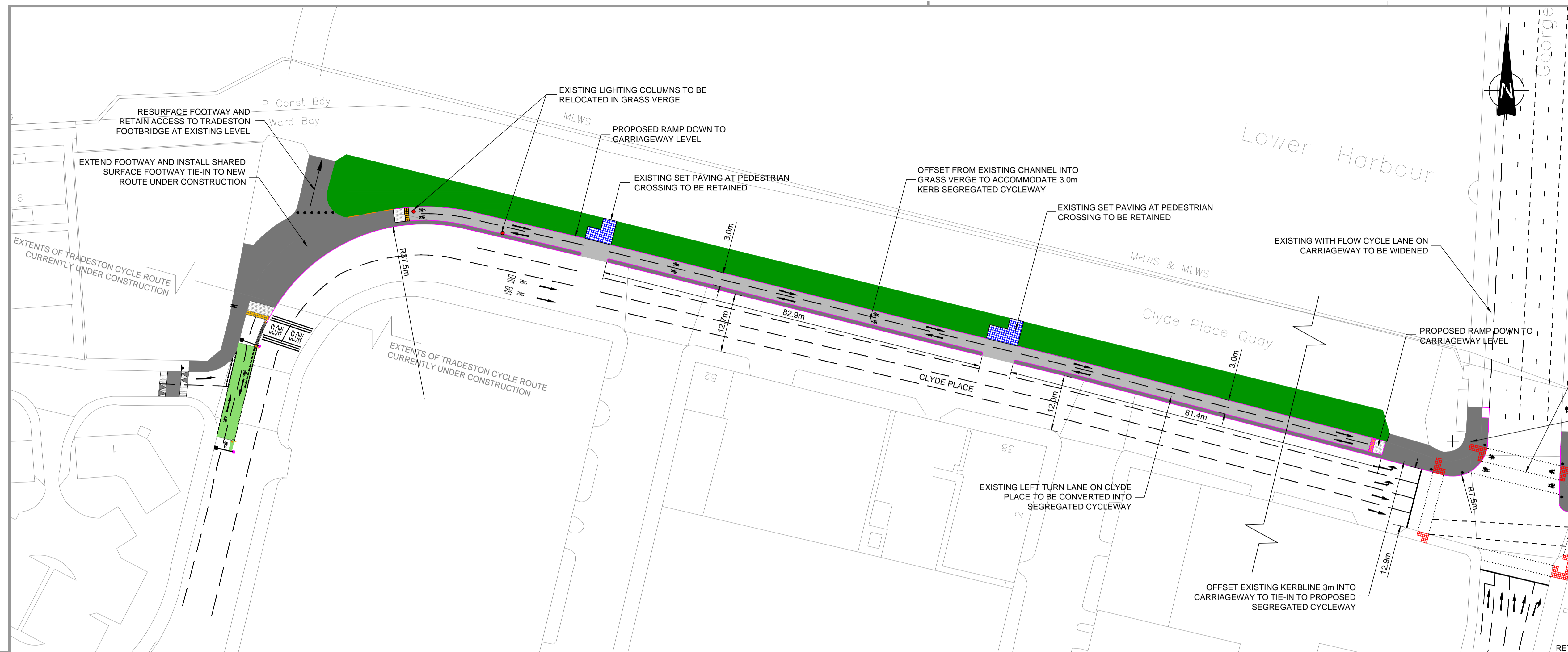

Rev.	Date	Revisions	Checked Date	Appvd Date
Glasgow City Council				
Scale	: 1:500	Date	: AUG_2015	
Prepared by	: LL	Checked by	: WM	
Traced by	: ACAD_2014	Approved by	: PM	
Executive Director of Land and Environmental Services: Brian Devlin				
Design Office: Exchange House, 231 George Street, G1 1RX				
RIVER CLYDE SOUTH BANK COMMUTER ROUTE				
PRELIMINARY DESIGN CLYDE PLACE				
Drawing No:	425040-002			
Rev:				
File No:	425040			
Drawing Status:	Prelim.	<input checked="" type="checkbox"/> Tender	<input type="checkbox"/> Contract	<input type="checkbox"/> Record
Client:	PROJECT MANAGEMENT AND DESIGN			
Original Drawing Size:	841 * 594 (A1)			

DRAFT

