

## **THE EAST DUNBARTONSHIRE COUNCIL**

### **BEARSDEN AND MILNGAVIE SCHOOLS**

#### **PROPOSED WAITING AND LOADING RESTRICTIONS**

East Dunbartonshire Council propose to consider the introduction of a Traffic Regulation Order introducing waiting and loading restrictions on sections of roads in the vicinity of : -  
(i) Clober Primary School, Milngavie; and (ii) Westerton Primary School, Bearsden.

Full details of this proposal, which forms the proposed THE EAST DUNBARTONSHIRE COUNCIL (BEARSDEN AND MILNGAVIE SCHOOLS) (WAITING AND LOADING RESTRICTIONS) ORDER, together with a plan and Statement of Reasons for proposing to make this Order, are available for inspection during normal office hours Monday to Friday inclusive at the offices of:-

- (i) Roads & Transportation, Broomhill Industrial Estate, Kilsyth Road, Kirkintilloch, G66 1TF (Telephone Enquiries to: 0300-123-4510);
- (ii) Legal Services, 12 Strathkelvin Place, Kirkintilloch, G66 1TJ (Telephone Enquiries to: 0300-123-4510);

and also at the following offices during their normal opening hours

- (iii) Bearsden Community Hub, 69 Drymen Road, Bearsden, G61 3QT;
- (iv) Milngavie Library, Allander Road, Milngavie, G62 8PN;
- (v) Westerton Library, 82 Maxwell Avenue, Bearsden, G61 1NZ.

Any person wishing to object to the proposal should send details of the grounds for objection in writing to the Chief Solicitor & Monitoring Officer, 12 Strathkelvin Place, Kirkintilloch, G66 1TJ by Monday, 7 October 2019

Karen Donnelly  
Chief Solicitor & Monitoring Officer  
12 Strathkelvin Place  
Kirkintilloch  
G66 1TJ.

**THE EAST DUNBARTONSHIRE COUNCIL**

**(BEARSDEN AND MILNGAVIE SCHOOLS)**

**(WAITING AND LOADING RESTRICTIONS) ORDER 20XX**

The East Dunbartonshire Council in exercise of the powers conferred on them by sections 1(1), 2(1) to (3) and Part IV of Schedule 9 of the Road Traffic Regulation Act 1984 ("the Act") and of all other enabling powers and after consultation with the Chief Constable of the Police Service of Scotland in accordance with Part III of Schedule 9 to the Act hereby make the following Order.

1. This Order may be cited as "The East Dunbartonshire Council (Bearsden and Milngavie Schools) (Waiting and Loading Restrictions) Order 20XX and shall come into operation on XXXXX.

2. In this Order the following expressions have the meanings hereby assigned to them:-

**"vehicle"** unless the context otherwise requires, means a vehicle of any description and includes a machine or implement of any kind drawn or propelled along roads whether or not by mechanical power;

**"taxi"** has the same meaning as in Section 23(1) of the Civic Government (Scotland) Act 1982;

**"disabled person's badge"** has the same meaning as in the Local Authorities Traffic Orders (Exemptions for Disabled Persons) (Scotland) Regulations 2002;

**"emergency services vehicle"** means a vehicle being used by the Police, Fire Brigade or Ambulance Services;

**"local authority"** means a Council constituted by Section 2 of the Local Government etc (Scotland) Act 1994;

**"Council"** means the East Dunbartonshire Council incorporated under the Local Government etc (Scotland) Act 1994;

3. Save as provided in Article 5 of this Order no person shall, except upon the direction or with permission of a police constable in uniform or traffic warden in uniform cause or permit any vehicle to stop between the hours of 8:30 am and 4:30 pm, Monday to Friday inclusive in the lengths of road specified in Schedule 1 to this Order.
4. Nothing in Article 3 shall apply:-
  - (a) so as to prevent any vehicle waiting in the said lengths of roads for so long as may be necessary to enable the vehicle, if it cannot be used for

such purpose without so waiting, to be used in connection with any building operation or demolition being carried on adjacent thereto, the removal of any obstruction or potential obstruction to traffic, the maintenance, testing, alteration, repair or removal of any structure, works, or apparatus in, on, under or over the road;

- (b) to an emergency services vehicle;
  - (c) to a vehicle being used in the service of the local authority or with the permission of the local authority in exercise of statutory powers and duties if it is necessary for the vehicle while being so used to wait in the said lengths of road;
  - (d) to a vehicle waiting in any case where the person in control of the vehicle:-
    - (i) is required by law to stop;
    - (ii) is obliged to do so in order to avoid an accident;
    - (iii) is prevented from proceeding by circumstances outwith his control and it is not reasonably practicable for him to drive or move the vehicle to a place not within the said lengths of roads.
5. Save as provided in Article 7 of this Order no person shall, except upon the direction or with the permission of a police constable in uniform or a traffic warden in uniform cause or permit any vehicle to wait at any time in the lengths of roads specified in Schedule 2 to this Order.
6. Save as provided in Article 7 of this Order no person shall, except upon the direction or with the permission of a police constable in uniform or a traffic warden in uniform, cause or permit any vehicle to wait between the hours of 8:30 am and 9:30 am and between the hours of 2:30 pm and 4:30 pm, Monday to Friday inclusive, in any of the lengths of road specified in Schedule 3 to this Order.
- 8 Nothing in Article 6 and 7 of this Order shall :-
- (a) prevent any person from causing or permitting a vehicle to wait in any of the lengths of road referred to in that Article:-
    - (i) for so long as may be necessary to enable a person to board or alight from the vehicle or to load thereon or unload therefrom their personal luggage;
    - (ii) for so long as may be necessary to enable the vehicle, if it cannot conveniently be used for such purpose in any other road, to be used in connection with any building operation or demolition, the removal of any obstruction to traffic, the maintenance, improvement or reconstruction of any of the lengths of roads so referred to, or the laying, erection, alteration or repair in or near to any of the said lengths of roads, of any sewer or of any main, pipe or apparatus for the supply of gas,

water or electricity, or of any telecommunications apparatus as defined in the Telecommunications Act 1984;

- (iii) to enable the vehicle, if it cannot conveniently be used for such purpose in any other road, to be used in pursuance of statutory powers and duties and in particular, but without prejudice to the generality of the foregoing, to enable the vehicle to be used in connection with police, fire brigade and ambulance purposes;
  - (iv) if the vehicle is waiting owing to the driver being prevented from proceeding by circumstances beyond their control or to such waiting being necessary in order to avoid an accident;
  - (v) if the vehicle is waiting in any of the lengths of roads while postal packets addressed to premises adjacent thereto are being unloaded from the vehicle or having been unloaded therefrom are being delivered or while postal packets are being collected from premises or posting boxes adjacent thereto;
  - (vi) for the purpose of loading or unloading the vehicle while the vehicle is standing at the kerb and is in actual use in connection with the removal of furniture from one office or dwelling house to another or the removal of furniture from such premises to a depository or to such premises from a depository;
  - (vii) to enable the vehicle to be used in connection with wedding and funeral operations.
- (b) apply to a licenced taxi waiting in a taxi stance during any period for which that stance has been designated by the Council under the Civic Government (Scotland) Act 1982.

Sealed with the Common Seal of the Council and subscribed for them and on their behalf by Karen M Donnelly, Chief Solicitor & Monitoring Officer at Kirkintilloch on the XXXXXXX

.....  
**KAREN M DONNELLY**  
**CHIEF SOLICITOR & MONITORING OFFICER**

SCHEDULE 1

NO STOPPING,  
8:30AM – 4:30PM, MONDAYS TO FRIDAYS.

Lengths of Road within East Dunbartonshire

Side of Road to which  
Restriction Applies

Bearsden

Crarae Avenue

- |  |      |
|--|------|
| 1. From a point 16 metres northeast of the extended north kerbline of Westfield crescent southwards for a distance of 43 metres. | West |
| 2. From a point 23 metres south of the extended south kerbline of Westfield Crescent southwards for a distance of 43 metres.     | West |

Kirk Street

- |  |           |
|--|-----------|
| 1. From a point 10 metres southeast of the extended southeast kerbline of Hunter Road south-eastwards for a distance of 40 metres. | Northeast |
| 2. From a point 50 metres southeast of the extended southeast kerbline of Hunter Road south-eastwards for a distance of metres.    | Northeast |

.....  
**KAREN M DONNELLY**  
**CHIEF SOLICITOR & MONITORING OFFICER**

SCHEDULE 2

NO WAITING AND NO LOADING AT ANY TIME.

Lengths of Road within East Dunbartonshire

Side of Road to which  
Restriction Applies

Bearsden

Access to Westerton Primary School

1. The entire length of the road. Both

Kirk Street

1. From the extended southeast kerblines of Hunter Roads south-eastwards for a distance of 10 metres. Both

Milngavie

Hunter Road

1. From a point 15 metres northeast of the extended northeast kerblines of Kirk Street south-westwards to a point 15 metres southwest of the extended southwest kerblines of Kirk Street. Both

.....  
KAREN M DONNELLY  
CHIEF SOLICITOR & MONITORING OFFICER

SCHEDULE 3

NO WAITING AND NO LOADING,  
8:30AM-9:30AM, 2:30PM-4:30PM, MONDAYS TO FRIDAYS

Lengths of Road within East Dunbartonshire

Side of Road to which  
Restriction Applies

Bearsden

Crarae Avenue

1. From a point 15 metres northwest of the extended northwest kerbline of Westfield Crescent southwards to a point 36 metres south of the extended south kerbline of Westfield Crescent.

East

Kirk Street

1. From a point 10 metres southeast of the extended southeast kerbline of Hunter Road south-eastwards to a point 10 metres southeast of the extended southeast kerbline of Craigielee Crescent.

Southwest

Westfield Crescent

1. From the extended east kerbline of Crarae Avenue eastwards for a distance of 15 metres.

East

Milngavie

Craigielea Crescent

1. From the extended southwest kerbline of Kirk Street south-westwards for a distance of 10 metres.

Both

Hunter Road

1. From a point 15 metres northeast of the extended northeast kerbline of Kirk Street north-eastwards for a distance of 32 metres.

Southeast

2. from a point 35 metres northeast of the extended northeast kerbline of Kirk Street north-eastwards for a distance of 12 metres.

Southeast





.....  
KAREN M DONNELLY  
CHIEF SOLICITOR & MONITORING OFFICER

The East Dunbartonshire Council  
(Bearsden and Milngavie Schools)  
(Waiting and Loading Restrictions) Order 20...

Statement of Reasons for Proposing to Make the Above Order

It is considered necessary to make the above order to remove dangerous and obstructive parking around the accesses to various schools in the area.



-  No stopping  
8.30am - 9.30am, 2.30pm - 4.30pm,  
Mondays to Fridays
-  No stopping except buses  
8.30am - 9.30am, 2.30pm - 4.30pm,  
Mondays to Fridays
-  No waiting and no loading at any time
-  No waiting and no loading  
8.30am - 9.30am, 2.30pm - 4.30pm,  
Mondays to Fridays
-  Advisory white "KEEP CLEAR"

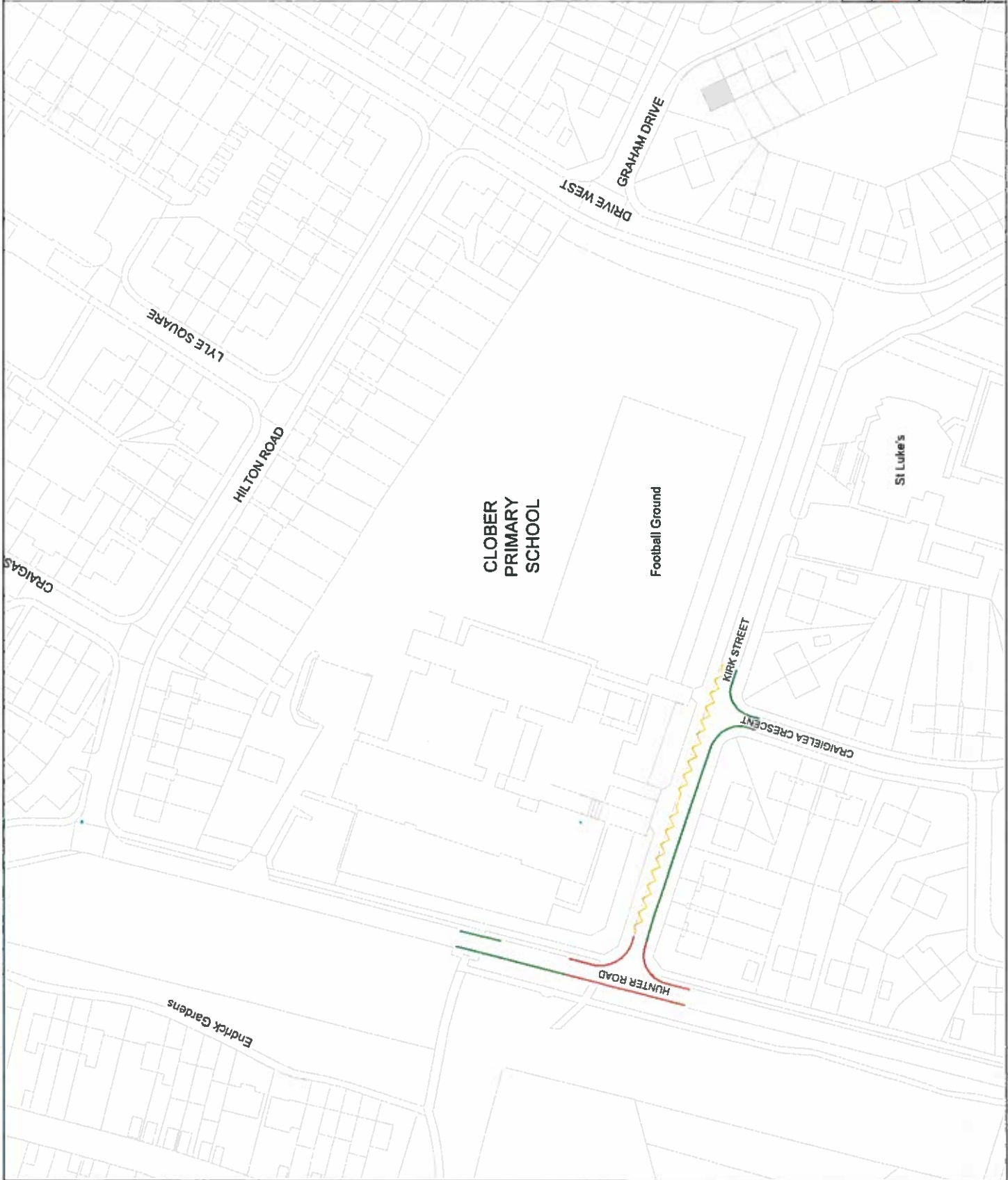





This map is intended to be used in conjunction with the provisions of the Traffic Signs Regulations and General Directions 2002 (TSRGD) and the Traffic Signs Manual (TSM) and may be subject to change without notice.

**sustainable thriving achieving**  
**East Dunbartonshire Council**  
[www.eastdunbarton.gov.uk](http://www.eastdunbarton.gov.uk)

East Dunbartonshire Council Schools - West  
 Proposed Traffic Regulations Orders  
 Clobber Primary School, Milngavie

DATE: May 2018  
 DRAWN BY: JCM  
 SCALE: 1:1000  
 DATE: 13.5.18  
 FILE REF: EDC-SKC-001

-  No stopping  
8:30am - 9:30am, 2:30pm - 4:30pm,  
Mondays to Fridays
-  No stopping except buses  
8:30am - 9:30am, 2:30pm - 4:30pm,  
Mondays to Fridays
-  No waiting and no loading at any time
-  No waiting and no loading  
8:30am - 9:30am, 2:30pm - 4:30pm,  
Mondays to Fridays
-  Advisory white "KEEP CLEAR"

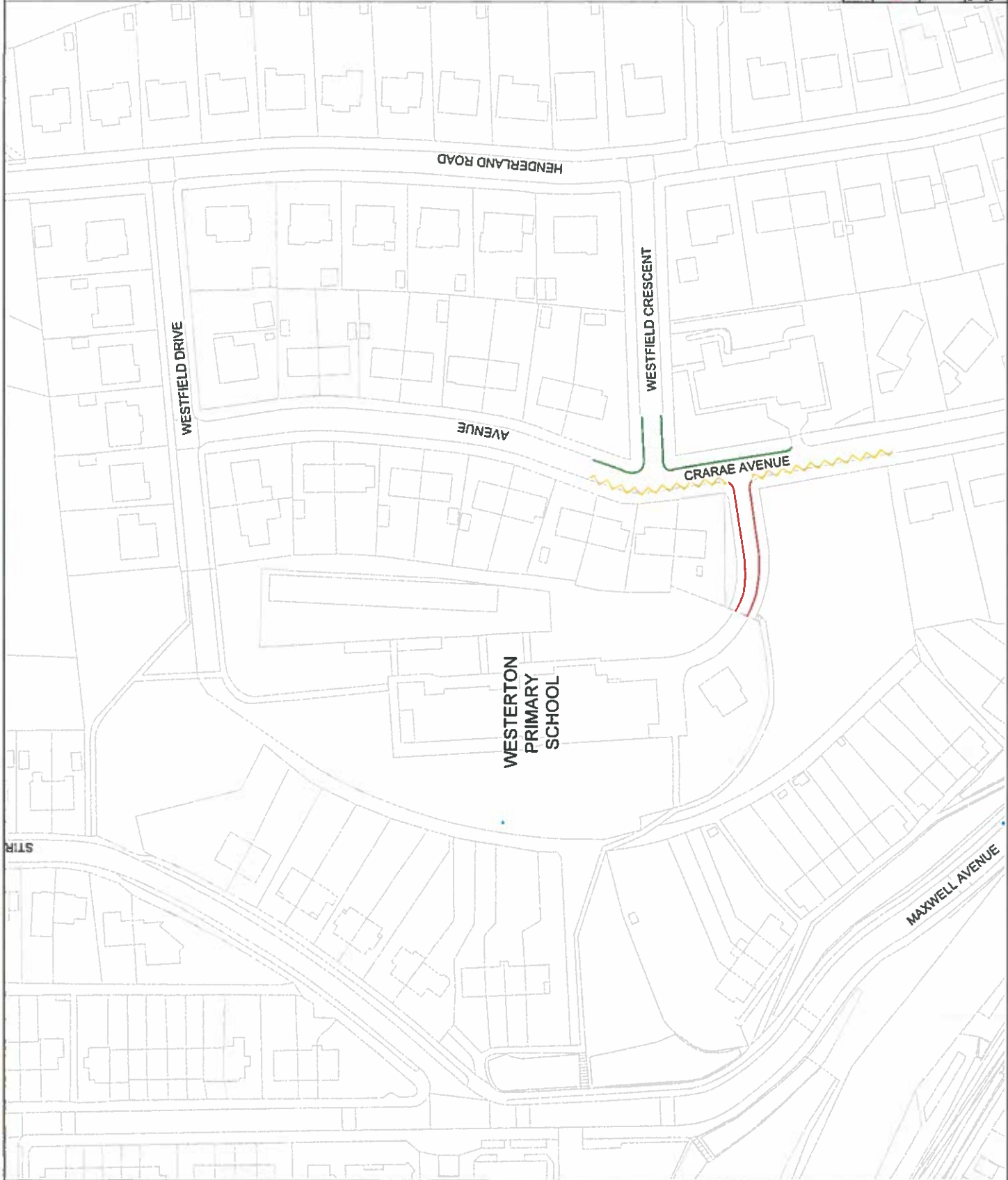

This map is unapproved for circulation. Any use without the permission of Dunbarton Council is prohibited. The map is the property of Dunbarton Council and its use for any other purpose is prohibited. © Dunbarton Council 2018.

**sustainable driving achieving**  
**East Dunbartonshire Council**  
[www.eastdunbarton.gov.uk](http://www.eastdunbarton.gov.uk)

East Dunbartonshire Council Schools - West  
 Proposed Traffic Regulations Orders  
 Westerton Primary School, Bearsden

DATE	MAY 2018	DESIGNED BY	JGA	SCALE	1:1000	DRAWN BY	PL
FILE REF		ORDER NO.					EDC-SKC-002