

# TORYGLEN GREEN INFRASTRUCTURE & ACCESS PROJECT – SECTION 3 ADVANCE WORKS

## FOOTPATH CLOSURES AND PEDESTRIAN DIVERSION ROUTE:



**CLOSURES AT PROSPECTHILL CIRCUS and Mall's Mire Woodland Footpath:**  
Footpath closure from 23<sup>rd</sup> November, 2020 for 8 weeks

**CLOSURE AT PINKERTON AVE & TORYGLEN RD:**  
Footpath closure from 23<sup>rd</sup> November 2020 for 8 weeks

**Footpath Diversion via Prospecthill Road/Westmuir Place:**  
Toryglen Park footpath diversion from 23<sup>rd</sup> November, 2020 for 8 weeks

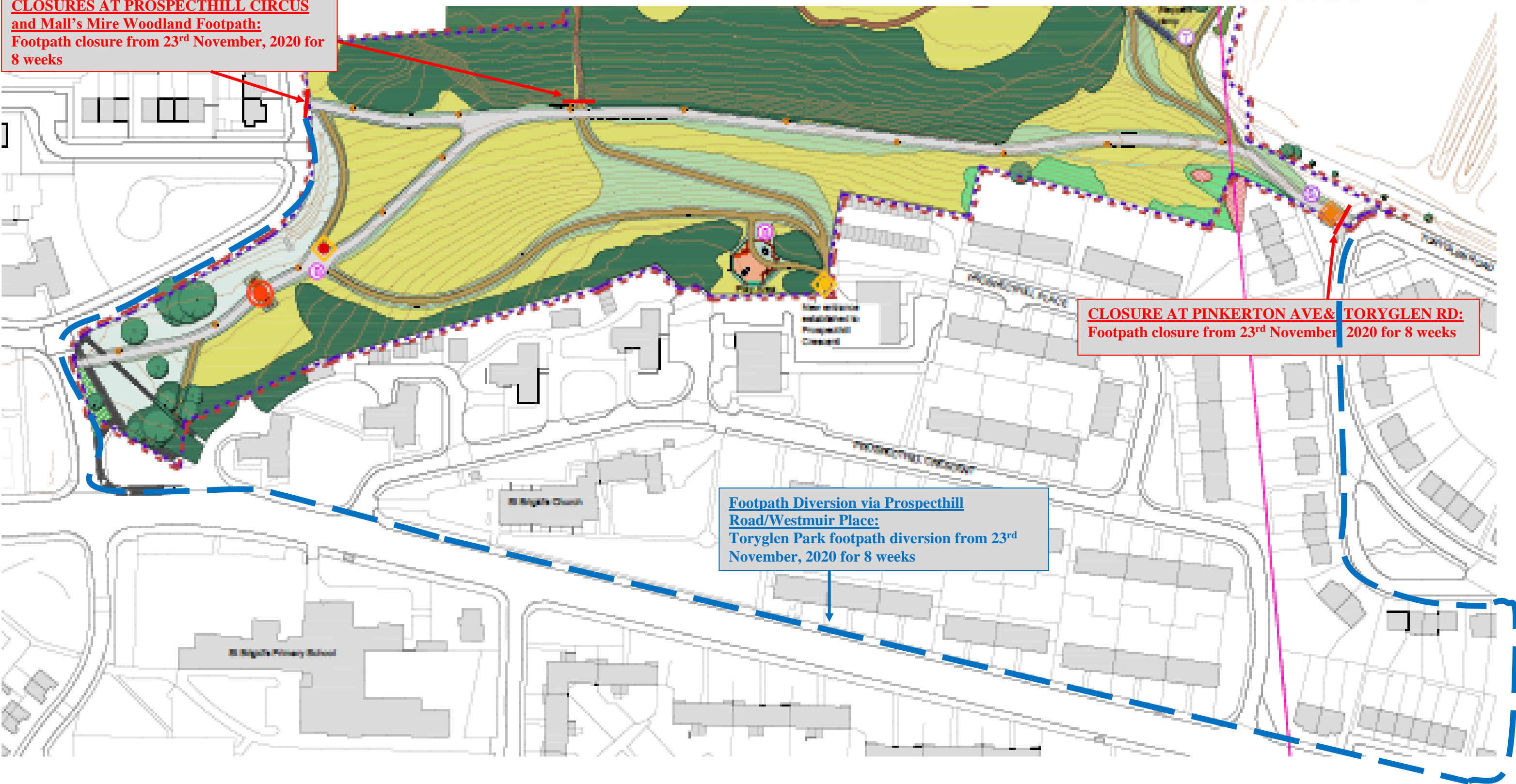

### LEGEND

- Footpath Closure ———
- Footpath Diversion (existing footpath) - - - - -

SITE SKETCH 018-161120  
Footpath Closures & Pedestrian Diversion